

# MOTOR CAPACITOR-CBB61

Suntan®

ELECTRICAL APPARATUE USE METALLIZED FILM WITH PRECISELY QUALITY CONTROL

## FEATURES

# TS11

- High safety. High reliability
- High I.R. (insulation resistance) small size.
- Low D.F. (dissipation factor), lower temperature rise.
- Durability and characteristics of frequency, etc..



## S P E C I F I C A T I O N S

|                       |   |
|-----------------------|---|
| OPERATING CONDITION   | -40°C ~ +85°C   |
| CAPACITANCE RANGE     | 1µF ~ 20µF (TS11-B ~ D, TS11-5 ~ 7, TS11-9)                       |
| CAPACITANCE TOLERANCE | J(±5%)、K(±10%)  |
| RATED VOLTAGE         | 250V 450V (AC)  |
| WITHSTAND VOLTAGE     | AC ≥ 2U <sub>R</sub> 2S (I <sub>max</sub> ≤ 1.3 I <sub>nA</sub> ) |
| DISSIPATION FACTORY   | ≤ 0.003 1KHz  |
| INSULATION RESISTANCE | ≥ 3000S   |

TS11-B

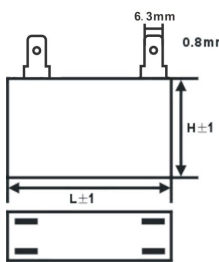

TS11-C

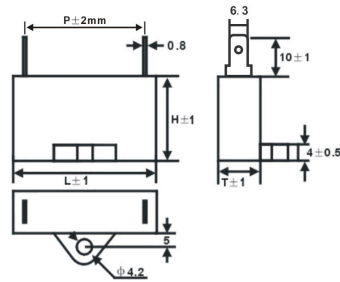

TS11-D

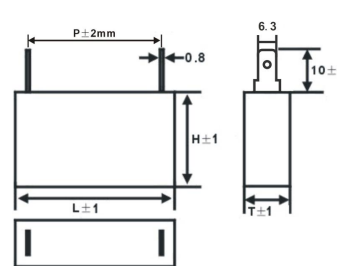

TS11-5

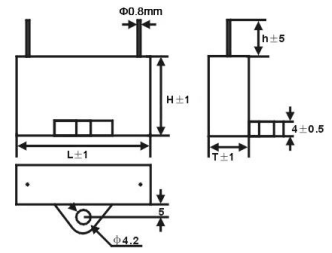

TS11-6

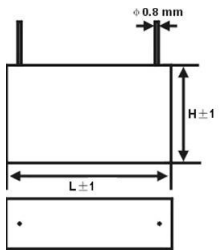

TS11-7

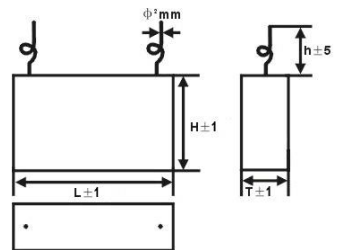

TS11-8

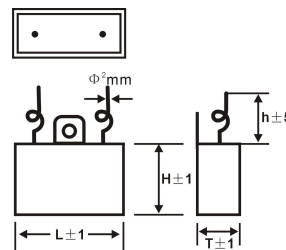

TS11-9

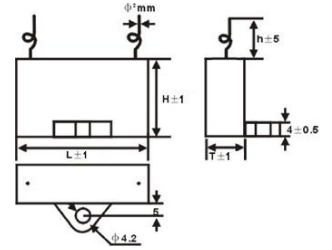

Remark: PVC wires are not guarantee centered on the bottom, the wire position not affect the capacitors performance.

### Dimensions (mm)

| CAP | TS11-C, TS11-5 |      |    |        |      |    | TS11-B, TS11-D |    |    |        |    |    |
|-----|----------------|------|----|--------|------|----|----------------|----|----|--------|----|----|
|     | 250VAC         |      |    | 450VAC |      |    | 250VAC         |    |    | 450VAC |    |    |
| µF  | L              | T    | H  | L      | T    | H  | L              | T  | H  | L      | T  | H  |
| 0.5 | 26.5           | 12.5 | 21 | 26.5   | 12.5 | 21 | 26.5           | 12 | 20 | 25.5   | 12 | 20 |
| 1   | 26.5           | 12.5 | 21 | 32     | 14   | 24 | 26.5           | 12 | 20 | 32     | 14 | 25 |
| 2   | 32             | 14   | 24 | 37     | 17   | 28 | 32             | 14 | 25 | 37     | 17 | 28 |
| 2.5 | 32             | 14   | 24 | 37     | 17   | 28 | 32             | 14 | 25 | 37     | 17 | 28 |
| 3   | 32             | 14   | 24 | 38     | 20   | 30 | 32             | 14 | 25 | 38     | 20 | 30 |
| 5   | 37             | 17   | 28 | 47     | 20   | 34 | 37             | 17 | 28 | 47     | 20 | 34 |
| 6   | 37             | 17   | 28 | 47     | 23   | 34 | 37             | 17 | 28 | 47     | 23 | 34 |
| 8   | 47             | 17.5 | 33 | 47     | 28   | 34 | 47             | 18 | 32 | 47     | 28 | 34 |
| 10  | 47             | 17.5 | 33 | 47     | 32   | 40 | 47             | 18 | 32 | 47     | 30 | 40 |
| 12  | 47             | 23   | 34 | 47     | 32   | 43 | 47             | 23 | 34 | --     | -- | -- |
| 15  | 47             | 25   | 34 | --     | --   | -- | 47             | 25 | 34 | --     | -- | -- |
| 20  | 47             | 28   | 37 | --     | --   | -- | 47             | 28 | 37 | --     | -- | -- |

| CAP  | TS11-6 |      |        |      | TS11-7, TS11-9 |      |        |      |
|------|--------|------|--------|------|----------------|------|--------|------|
|      | 250VAC |      | 450VAC |      | 250VAC         |      | 450VAC |      |
| µF   | L      | T    | H      | P    | L              | T    | H      | P    |
| 0.5  | 32     | 10   | 20     | 27.5 | 32             | 10   | 20     | 27.5 |
| 1.0  | 32     | 10   | 20     | 27.5 | 36             | 10   | 20     | 31.5 |
| 1.2  | 36     | 10   | 20     | 31.5 | 36             | 11   | 22     | 31.5 |
| 1.5  | 36     | 10   | 20     | 31.5 | 36             | 12   | 22     | 31.5 |
| 1.8  | 36     | 11   | 22     | 31.5 | 36             | 12   | 22     | 31.5 |
| 2.0  | 36     | 11   | 22     | 31.5 | 37             | 13   | 23     | 31.5 |
| 2.5  | 37     | 12   | 21     | 31.5 | 38             | 15   | 25     | 31.5 |
| 3.0  | 37     | 13   | 23     | 31.5 | 38             | 17   | 28     | 31.5 |
| 3.5  | 38     | 15   | 25     | 31.5 | 38             | 18.5 | 29     | 31.5 |
| 4.0  | 38     | 17   | 28     | 31.5 | 38             | 18.5 | 29     | 31.5 |
| 4.5  | 38     | 17   | 28     | 31.5 | 38             | 21   | 32     | 31.5 |
| 5.0  | 38     | 18.5 | 29     | 31.5 | 38             | 24   | 33     | 31.5 |
| 6.0  | 38     | 19.5 | 31     | 31.5 | 38             | 24   | 33     | 31.5 |
| 7.0  | 38     | 21   | 32     | 31.5 | 47             | 23   | 35     | 41.5 |
| 8.0  | 38     | 24   | 33     | 31.5 | 47             | 26   | 38     | 41.5 |
| 10.0 | 47     | 23   | 35     | 41.5 | 47             | 26   | 38     | 41.5 |
| 12.0 | 47     | 23   | 35     | 41.5 | 48             | 33   | 45     | 41.5 |
| 15.0 | 47     | 26   | 38     | 41.5 | 48             | 33   | 45     | 41.5 |
| 16.0 | 47     | 26   | 38     | 41.5 | 57             | 32   | 44     | 51.5 |
| 18.0 | 47     | 26   | 38     | 41.5 | 57             | 32   | 44     | 51.5 |
| 20.0 | 48     | 33   | 45     | 41.5 | 57             | 32   | 44     | 51.5 |

Please visit our website to get more update data, those data & specification are subject to change without notice.