

TS23B



S P E C I F I C A T I O N S

RATED VOLTAGE	DC 500V
CAPACITANCE TOLERANCE	±5%
CAPACITANCE RANGE	5pF-1000pF
WITHSTANDING VOLTAGE	200 % OF RATED VOLTAGE FOR 1 TO 5 SECONDS (WITH SURGE CURRENT NOT EXCEEDING 5 mA).
INSULATION RESISTANCE	1000 MEGOHMS(min.) AT 100 VDC AND AT 25 DEG C.
TANGENT DELTA	5pF to 30pF→< 0.0020 (1 MHz) 31pF to 1000pF→< 0.0010 (1 MHz)
TEMPERATURE COEFFICIENT	(1 To 20pF) → -200 TO + 200 PPM/deg.C (21 To 56pF)→ -100 to +100 ppm/deg.C (57 To 1000pF) →-20 to + 100 ppm/deg. C (57 To 1000pF) → 0 to + 70 ppm/deg.C (On Request)
TEMPERATURE RANGE	-55°C~+200°C
TERMINALS	NON INDUCTIVE , SILVER PLATED

UNIT: mm

TYPE	RATED VDC	CAPACITANCE PF	L max	W max	T max
TS23B	500	1~100	16.36	10.70	3.5
	500	101~390	16.36	10.70	3.8
	500	391~1000	16.36	10.70	4.5

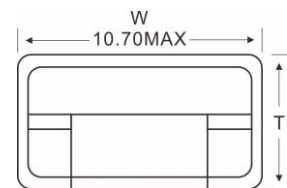
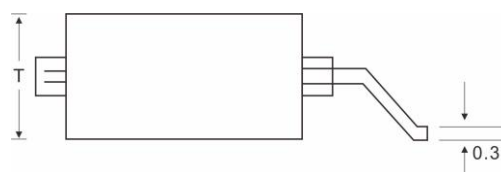
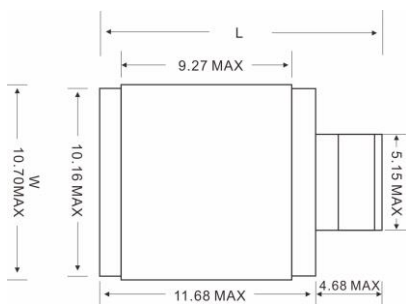

T→THICKNESS DEPENDING ON CAPACITANCE VALUE

Note: Specification are subject to change without notice. For more detail and update, please visit our website.