

# TSR-3386

## 玻璃釉微調電位器

■ 單圈的/金屬陶瓷/工業用/密封  
 (Single Turn/ Cermet/ Industrial/ Sealed)

■ 多種引線的安裝尺寸  
 (Many Terminal Styles)

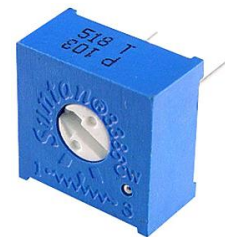

Electrical Characteristics	
Standard Resistance Range	10Ω - 5MΩ
Resistance Tolerance	±10% (±20% only for 10, 20 and 2M ohm)
Absolute Minimum Resistance	≤±1% R or 10Ω
Contact Resistance Variation	CRV≤±3% R or 5Ω
Insulation Resistance	R <sub>I</sub> ≥1GΩ(500Vdc)
Withstand Voltage	640Vac
Effective Travel	260°

共有尺寸 Common Dimensions

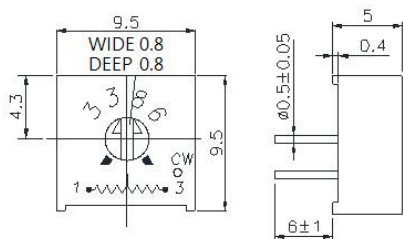

TSR-3386(STYLE) -EY5-(RESISTANCE CODE)

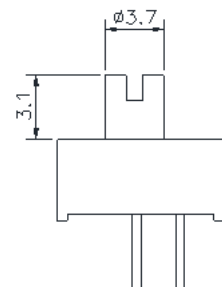

Environmental Characteristics	
Power Rating (300volts max)	0.5W@70°C, 0W@125°C
Temperature Range	-55°C ~ +125°C
Temperature Coefficient	General offer ±250x10 <sup>-6</sup> /°C (±100ppm/°C is available if request.)
Temperature Variation	-55°C/30min, +125°C/30min, 5 cycles ΔR≤±2%R, Δ(Uab/Uac)≤±2%R
Collision	390m/s <sup>2</sup> , 4000cycles, ΔR≤±1%R
Electrical Endurance at 70°C	0.5W@70°C, 1000h ΔR≤±(5%R+0.1Ω), CRV≤±3% R or 5Ω
Rotational Life	200 cycles ΔR≤±(10%R+0.5 Ω), CRV≤±3% or 5 Ω

TSR-3386P

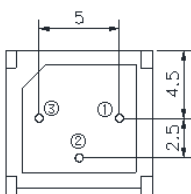

TSR-3386F

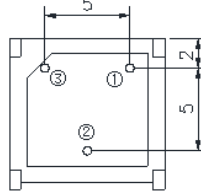

TSR-3386(STYLE)-EY5-(RESISTANCE CODE)-T

The Model 3386 is available with a knob for finger adjustment. Add suffix letter "T" to order code.

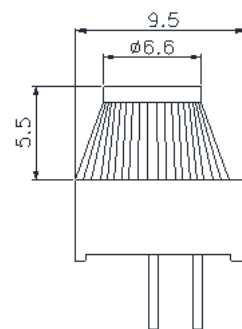

Physical Characteristics	
Starting torque	≤35mN·m
Marking	Resistance Tolerance (When no identification, it is of ± 10%) Resistance Code, Model
Standard Packaging	50pcs. per tube

TSR-3386Y

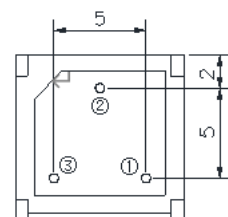

TSR-3386F,K,P,R,U,Y-EY5 (RESISTANCE CODE)-L

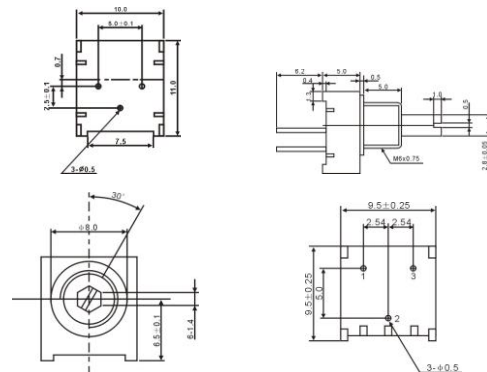

### Standard Resistance table

Resistance (Ohms)	Resistance Code	Resistance (Ohms)	Resistance Code
10	100	20,000	203
20	200	22,000	223
50	500	25,000	253
100	101	30,000	303
150	151	33,000	333
200	201	47,000	473
250	251	50,000	503
300	301	68,000	683
470	471	100,000	104
500	501	150,000	154
680	681	200,000	204
1,000	102	220,000	224
1,500	152	250,000	254
2,000	202	300,000	304
2,200	222	330,000	334
2,500	252	470,000	474
3,000	302	500,000	504
4,700	472	680,000	684
5,000	502	1,000,000	105
6,800	682	2,000,000	205
10,000	103	2,200,000	225
15,000	153	5,000,000	505

Special resistances available.

TSR-3386H

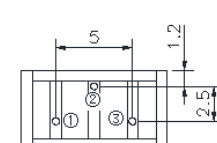

TSR-3386X

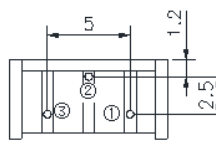

TSR-3386W

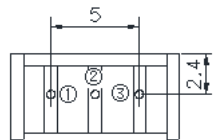

TSR-3386C

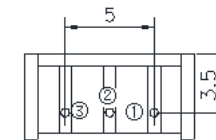

WIPER 2(d)

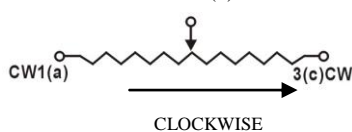

CLOCKWISE

Tolerance is ±0.25 if no identification

TSR-3386F,K,P,R,U,Y-EY5 (RESISTANCE CODE)-TL

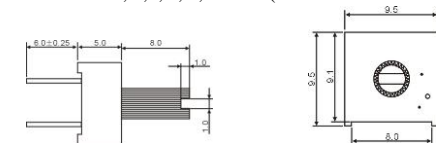

### How to Order

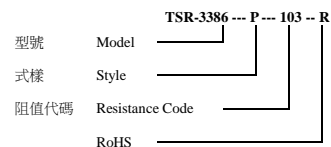

Note: Specification are subject to change without notice. For more detail and update, please visit our website.